

TSC TC200 / TTP-245C / SOLO T245C

Print Head Replacement Guide

This guide walks you through replacing the print head on a TSC TC200, TTP-245C, or SOLO T245C thermal label printer. The procedure is the same for all three models. Allow approximately 15-20 minutes and work on a clean, well-lit surface.

TOOLS YOU WILL NEED

- Large flat-head screwdriver
- Small flat-head screwdriver
- Medium Phillips screwdriver

STEP 1 Disconnect and open the printer

Disconnect power and data connections, then open the printer clamshell to expose the print head assembly. Lay out your screwdrivers ready to use.

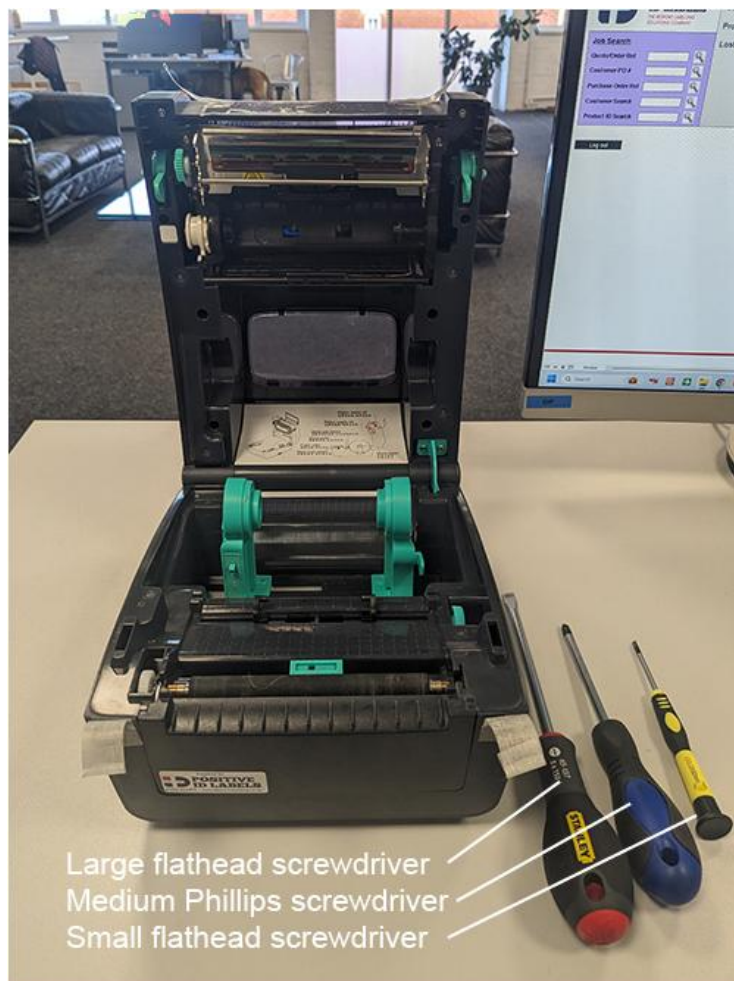

STEP 2 Rest the printer on the rear of the clamshell

Position the printer so it rests on the rear of the clamshell. This makes the underside of the head assembly easier to access.



NOTE

The clamshell lock should be in position to prevent the clamshell closing.

STEP 3 Identify the printhead cable harness cover

Locate the printhead cable harness cover and use the small flat-head screwdriver to lever it off. (See Step 4 image as well for orientation.)

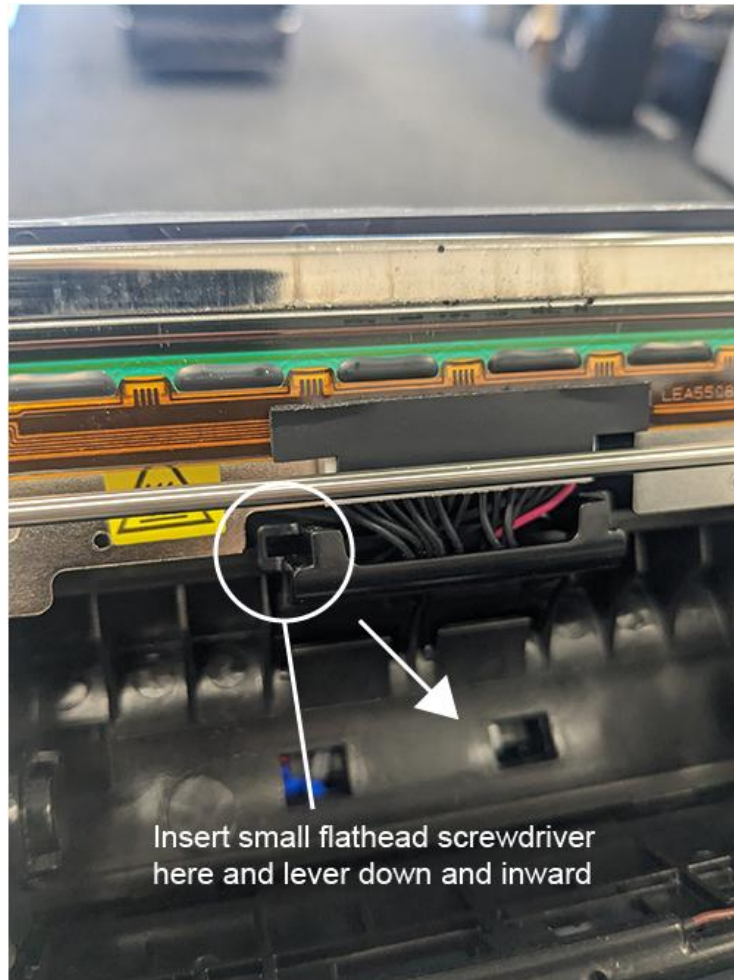

STEP 4 Lever the printhead cable harness free

Lever the harness cover in the direction indicated. Take your time and apply steady pressure.

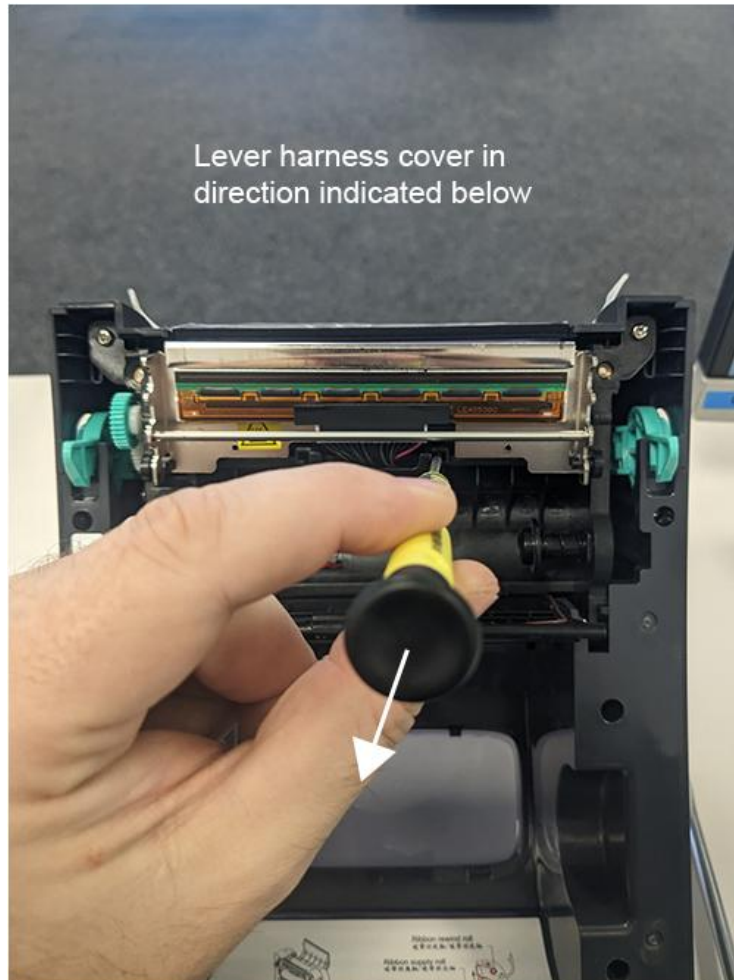

STEP 5 Remove the printhead cable harness

Once free, remove the cable harness cover and set it aside in a safe place — you will need it for reassembly.

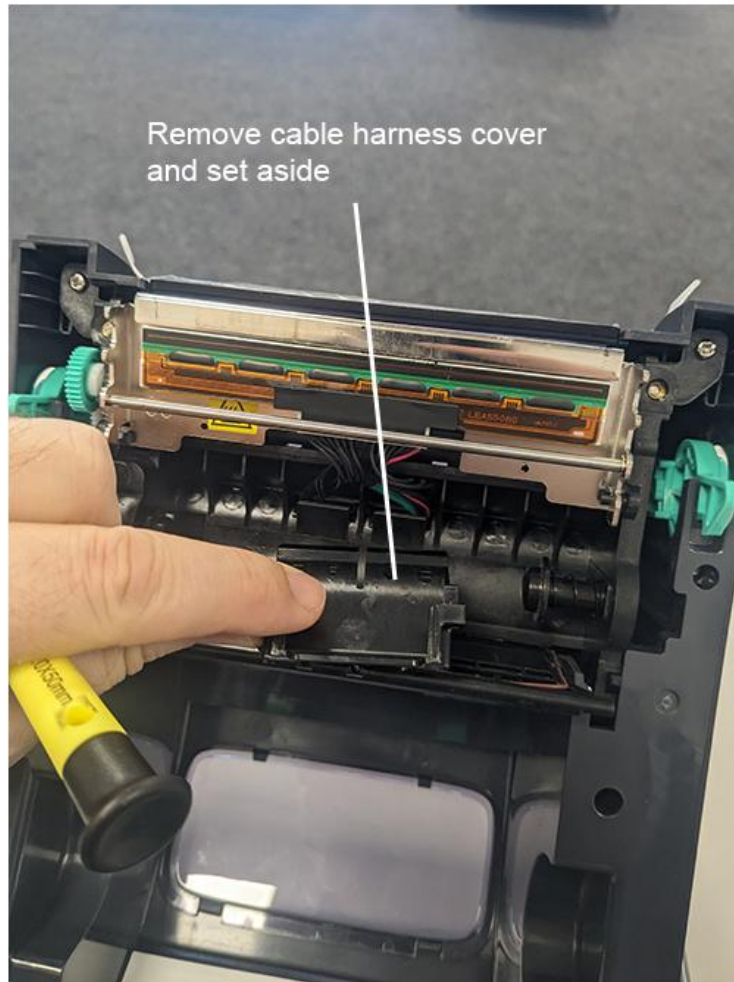

STEP 6 Remove the assembly retaining screws

Use the medium Phillips screwdriver to remove the assembly retaining screws from the printer's upper chassis.

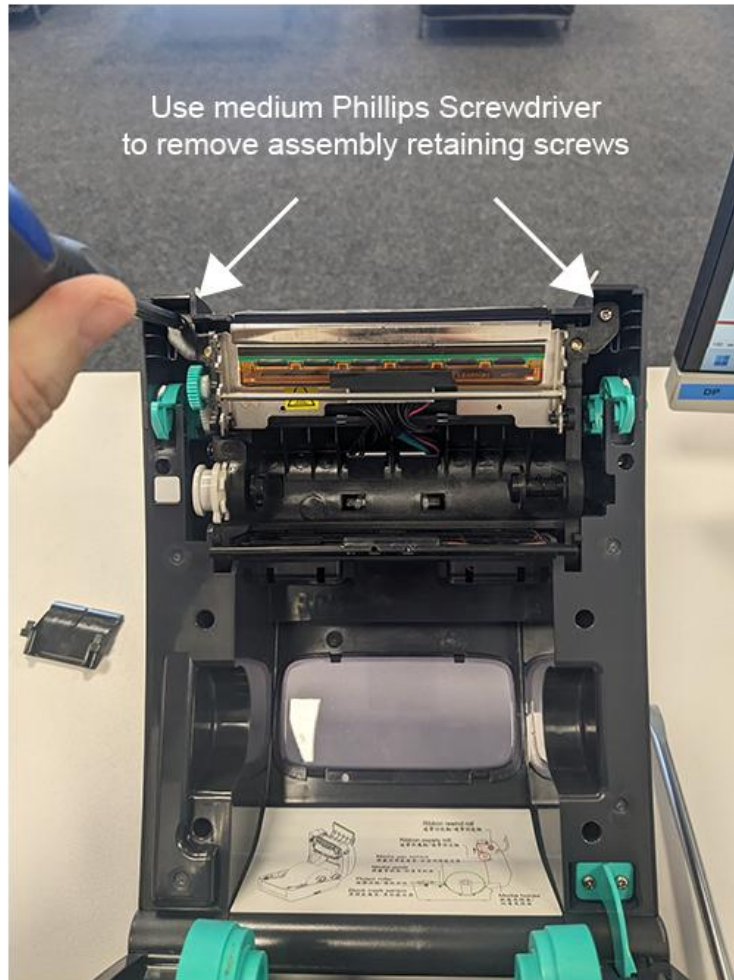

STEP 7 Reposition the printer on its base

Place the printer back on its base — the next steps need this orientation.



STEP 8 Open the thermal printer ribbon cover

Open the thermal printer ribbon cover to allow the printhead assembly to drop into the working position.

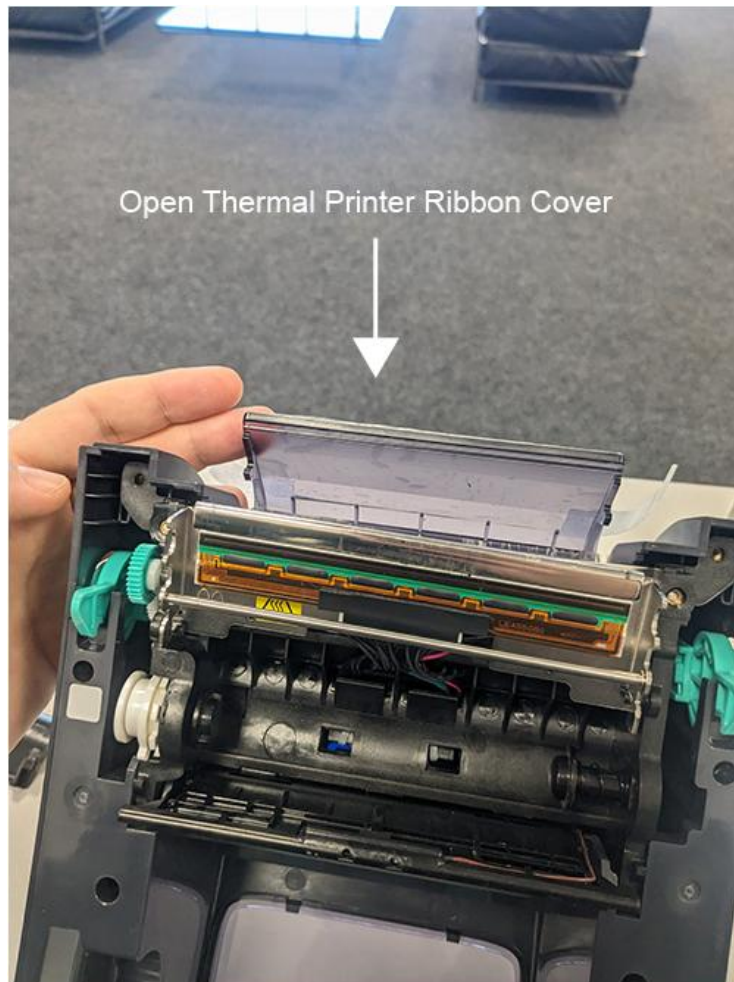

STEP 9 Unscrew the printhead from the assembly

Lower the printhead assembly and use the large flat-head screwdriver to detach the print head from the assembly.

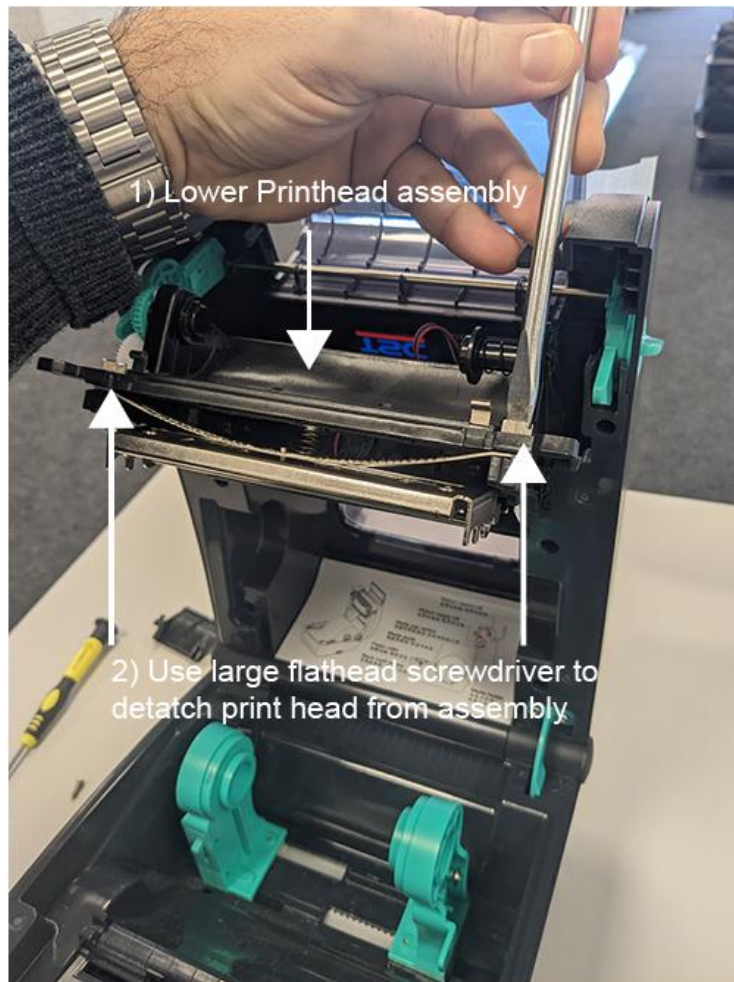

STEP 10 Lever the leaf spring from the printhead chassis

Lever the leaf spring component free of the assembly. Apply upward pressure to the leaf spring if necessary.

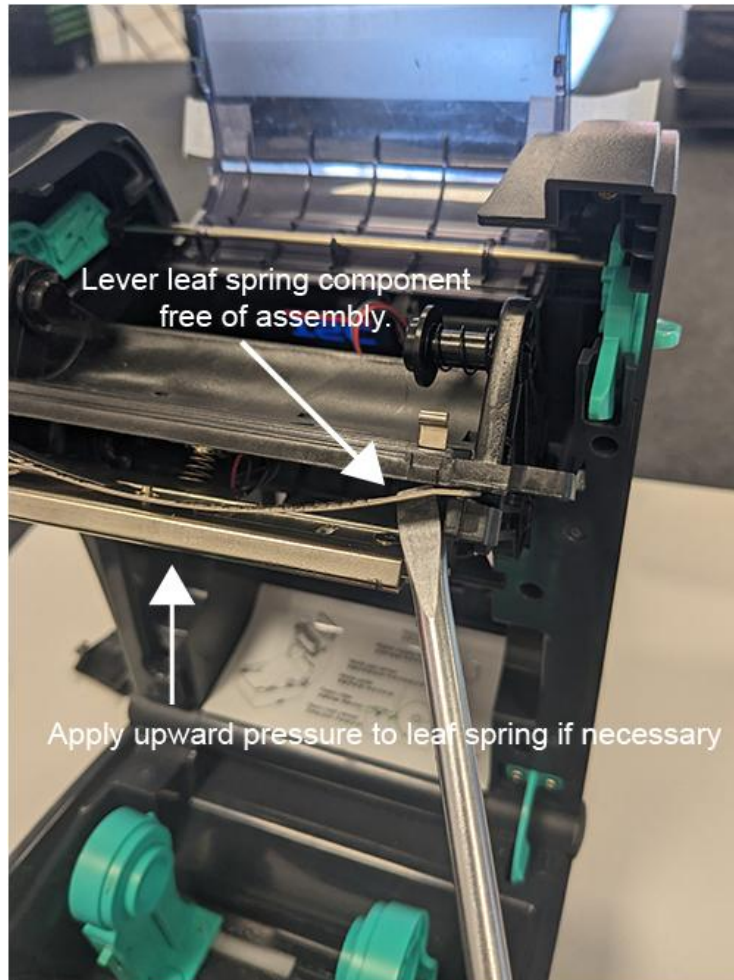

STEP 11 Disconnect the data ribbon

Manipulate the data connector plug by pinching the wires and/or levering the plug ends with the small flat-head screwdriver.

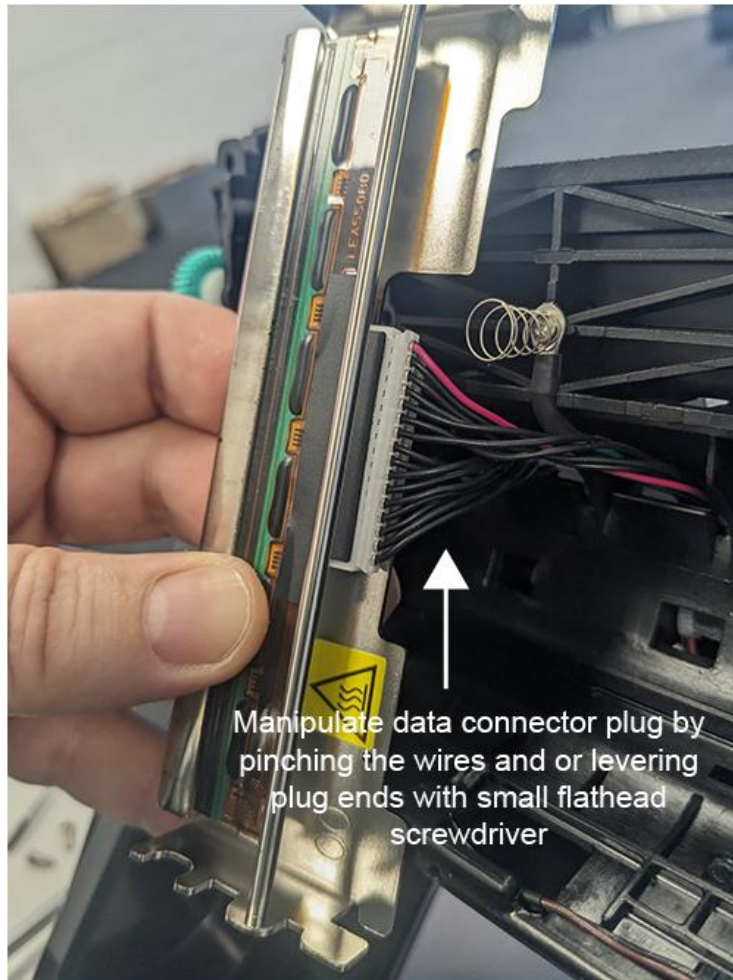

Manipulate data connector plug by pinching the wires and or levering plug ends with small flathead screwdriver

IMPORTANT

Take your time. This can be quite challenging — the plug you are removing is connected to the printer, so take care not to damage the connection. Rocking the plug from side to side can help with removal. It is an expensive component to replace and will require return of the equipment to Positive ID Labelling for repair if damaged.

STEP 12 Connect and seat the new printhead

Connect the new printhead to the data cable and offer the new printhead back into the printer chassis. Ensure both sides seat correctly as indicated. (See Step 13 image as well.)

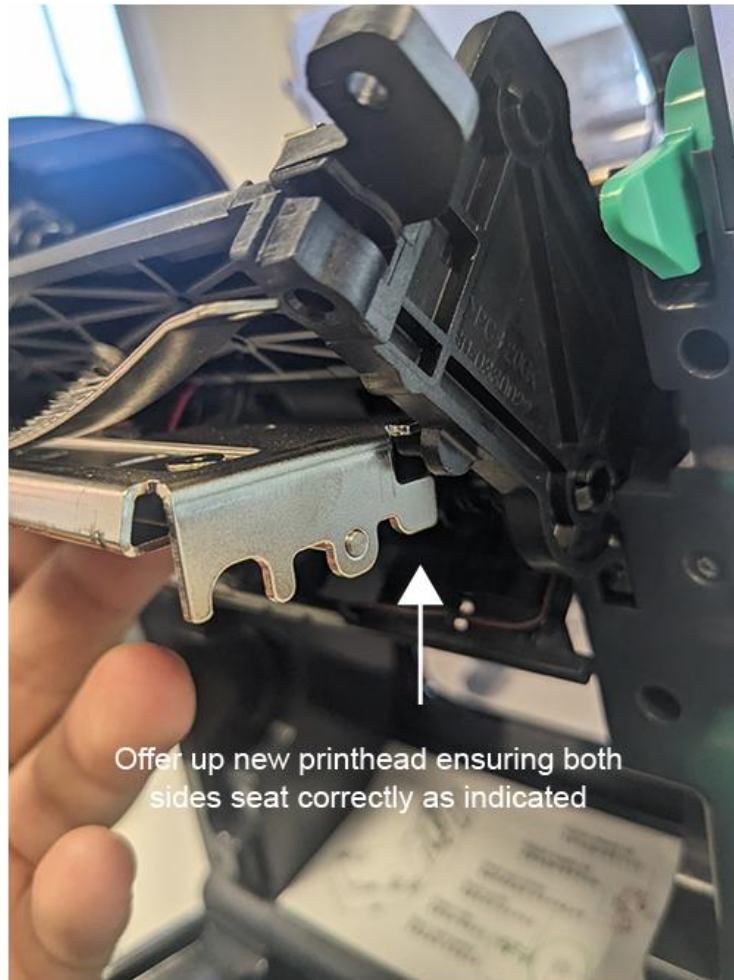

STEP 13 Reseat the leaf spring component

Offer the leaf spring component up into the retaining gap and push back to seat correctly. Apply pressure from below if needed to seat the spring properly.

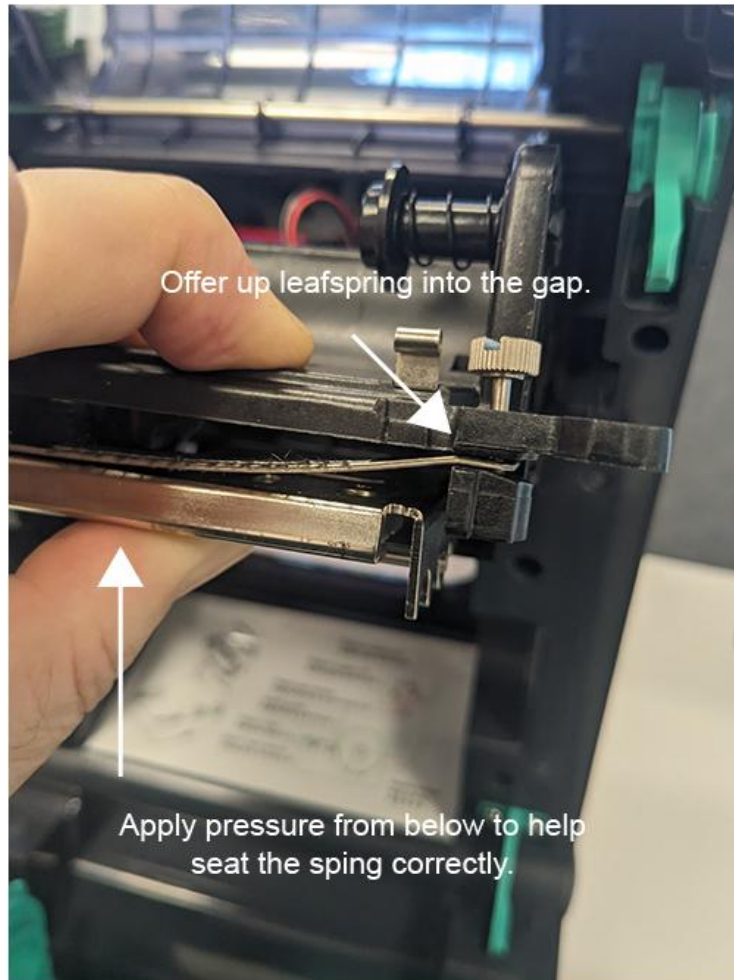

IMPORTANT

When inserting the screw, ensure it is offered up from the top — a common mistake is to offer it up from the underside. You will need to wiggle the component to allow the screw back into position. If, on completion, the printer will not close properly, it is because these screws have been inserted from the underside. Do not force the printer — reverse the process and ensure these large screws are seated on the top side of this assembly.

STEP 14 Screw the print head back into the main assembly

Reverse of Step 9. Refasten the print head to the assembly with the large flat-head screwdriver.

STEP 15 Screw the printhead assembly back into the printer chassis

Reverse of Step 6. Use the medium Phillips screwdriver to refit the assembly retaining screws.

STEP 16 Reseat the cable harness cover

Reverse of Step 5. You should not need the screwdriver to reseat the data cable cover.

STEP 17 Reseat the thermal printer ribbon cover

Reverse of Step 8. Close the ribbon cover to its original position.

STEP 18 Reconnect and test

Connect the printer to power and to your computer, then test with a label print.

NEED HELP?

If you encounter any difficulty during this procedure, our technical support team is here to help. We can also arrange return-to-base service if required.

Call 01332 864895 | **Email** support@pid-labelling.co.uk